



VIPERCS  
ASTM E 1745 CLASS A

VIPERCS  
ASTM E 1745 CLASS A



# VIPER™ CS

6.5-MIL

10-MIL

16-MIL

## VAPOR BARRIER

### CRAWL SPACE APPLICATION

VIPER™ CS is a "Class A" vapor barrier according to the ASTM E 1745 requirements. With physical characteristics including high puncture resistance, high tensile strength and low water vapor permeance, VIPER™ CS will prevent crawl space moisture from rising into the home or building.

VIPER™ CS is a triple-ply, extrusion coated, virgin polyethylene membrane. It is manufactured using woven, high-density fibers yielding the highest strength to weight ratio, tensile strength, tear resistance, bursting strength and puncture resistance of any product produced of its kind.

VIPER™ CS is also a moisture and radon barrier that provides an inexpensive insurance policy to protect from the negative effects that moisture can cause.

Some of these effects include:

- Mold
- Floor Failure
- Increased Electricity Bills
- Odors
- Insects
- Dust Mites
- Aggravated Allergies

### IMPORTANCE OF A CLEAN CRAWLSPACE

Traditional dirt crawl spaces are full of moisture, and without a vapor barrier the moisture has no where to go but up. Since warm air rises, the moisture sitting in the crawl space will rise and enter the entire building or home. Installing a vapor barrier provides the crawl space with a moisture protection layer to protect the structure from the negative effects of moisture.

### ADVANTAGES OF VIPER™ CS

When using VIPER™ CS in a crawl space application, you will be providing your home or building with the best protection on the market! By inhibiting moisture and soil gas migration, VIPER™ CS greatly reduces condensation, mold growth and poor breathing conditions within a home or building.

Other advantages include:

- Construction traffic no longer a concern due to its outstanding strength characteristics
- Mold resistant tape for seams prevents excess moisture from rising
- White color gives the crawlspace a fresh, clean look
- Self-adhesive backing for easy wall installation
- A sealed crawlspace can be used for storage
- Three different mil thicknesses: 6.5, 10 and 16

MADE IN  
THE  
U.S.A

### OTHER APPLICATIONS:

UNDER-SLAB  
FOUNDATION WALLS  
CRAWL SPACE

### ROLL SIZES:

12' x 200'  
(2400 SQ FT)



ASTM E 1745 CLASS A

## ASTM 1745 COMPARISON

ASTM E 1745	CLASS A	CLASS B	CLASS C
Water Vapor Permeance (E 154 Sec. 7 or F 1249) max	0.3 perms (0.3 gr/[hr•ft <sup>2</sup> •in.Hg])	0.3 perms (0.3 gr/[hr•ft <sup>2</sup> •in.Hg])	0.3 perms (0.3 gr/[hr•ft <sup>2</sup> •in.Hg])
Tensile Strength (E154 Sec. 9) min	45.0 lbf/in.	30.0 lbf/in.	13.6 lbf/in.
Puncture Resistance (D 1709 Method B) min	2200 g	1700 g	475 g

VIPER™ CS	6.5 MIL	10 MIL	16 MIL
Water Vapor Permeance (ASTM E 96) (E 154 Sec. 7 or F 1249) max	0.0095 perms	0.0016 perms	0.0015 perms
Tensile Strength (E 154 Sec. 9) min	69 lbf/in. (MD) 68 lbf/in. (TD)	136 lbf/in. (MD) 134 lbf/in. (TD)	167 lbf/in. (MD) 158 lbf/in. (TD)
Puncture Resistance (D 1709 Method B) min	8,825 g	15,839 g	25,335 g

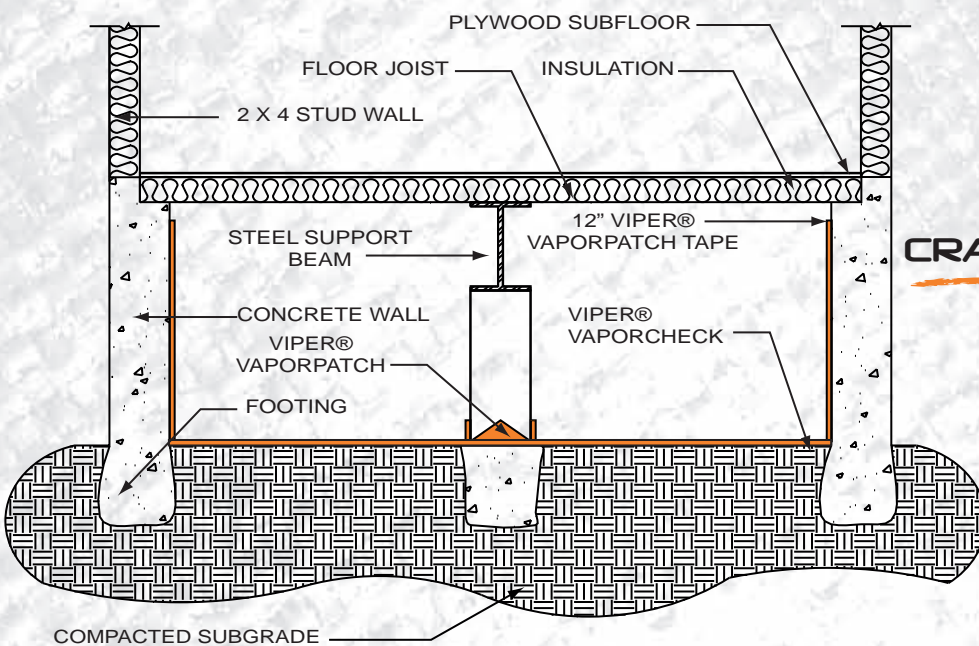

### CRAWL SPACE APPLICATION