



# VIPER® CS



## HIGH PERFORMANCE CRAWL SPACE VAPOR BARRIER

### VIPER® CS - INSTALLATION DETAIL

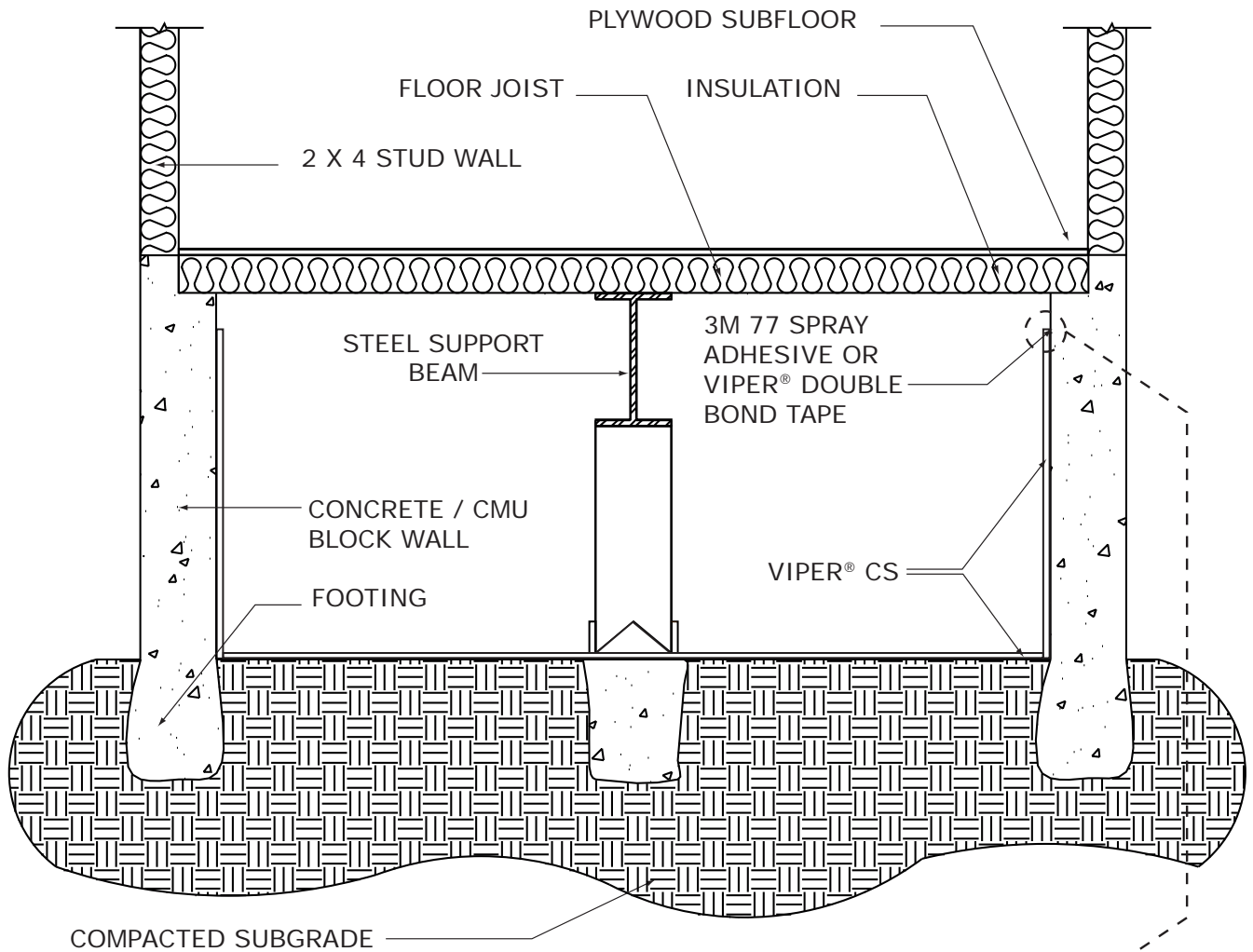

1. Apply Viper® Double Bond Tape along foundation wall at area of termination
2. Adhere Viper® CS to Double Bond Tape
3. Apply termination bar using mechanical fastener. Viper® Double Bond Tape will self-seal around fastener
4. Apply silicone caulk / sealant along top edge of termination

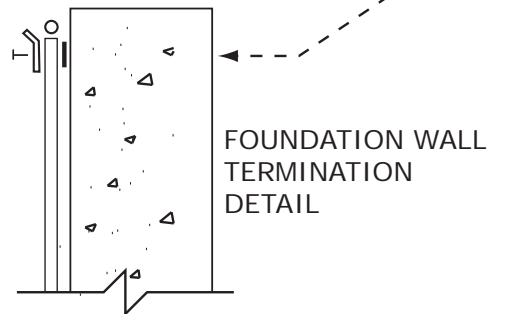

VIPER® CS • 6.5-mil • 10-mil • 16-mil • 12' x 200' • ASTM E 1745 "Class A" • MADE IN THE U.S.A

